

Optimal Resource Deployment of Paramedic Services Study

Joint Social Services and Land Ambulance Committee

November 13, 2024

ORH Report 2016



Emergency Service Planning
Emergency Medical Services

The Corporation of the City of Guelph
**Optimal Resource Deployment of
Emergency Services**

Final Report

August 3, 2016
ORH/CCG/1





Guelph-Wellington Paramedic Services

Paramedic Staffing and Deployment Needs Report

Final Report

Projected Emergency Call Volume Increases 2024 - 2034

Figure 3-3: Demand Projection

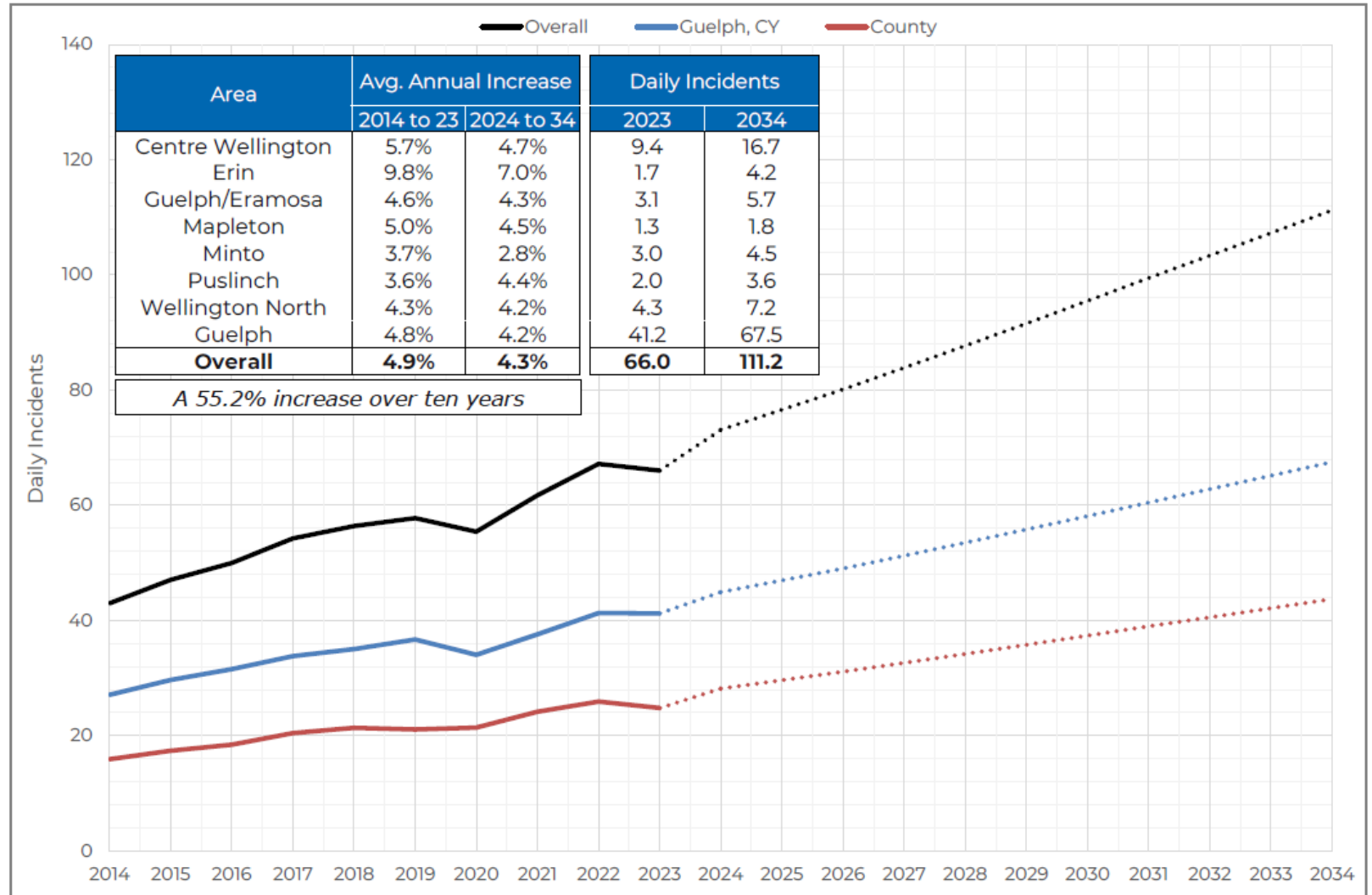

Proposed Targets based on Total Weighted Geometric Mean

LTM	Population	Area (sq km)	Population Density	TWGM	TWGM Rank	Base Position Performance		Proposed
						P4 % in 8 mins	P4 90th %ile	P4 90th %ile
Guelph	147,100	86.2	1,633.9	2,586.7	1	69.0%	10:58	11:00
Centre Wellington	32,204	415.3	74.9	354.2	2	61.8%	12:41	12:30
Guelph/Eramosa	14,297	297.4	56.5	156.9	3	28.3%	17:57	16:00
Wellington North	13,012	534.4	23.3	136.0	4	57.9%	17:33	16:00
Minto	9,572	301.2	30.2	122.4	5	29.9%	17:00	16:00
Erin	12,270	299.2	40.0	67.4	6	18.3%	19:34	18:00
Puslinch	8,166	219.2	36.2	41.9	7	10.6%	17:30	18:00
Mapleton	11,179	541.7	20.0	32.0	8	30.8%	19:17	18:00

Impact on Response Times 2024 – 2034

ORH 'Do Nothing' Scenario

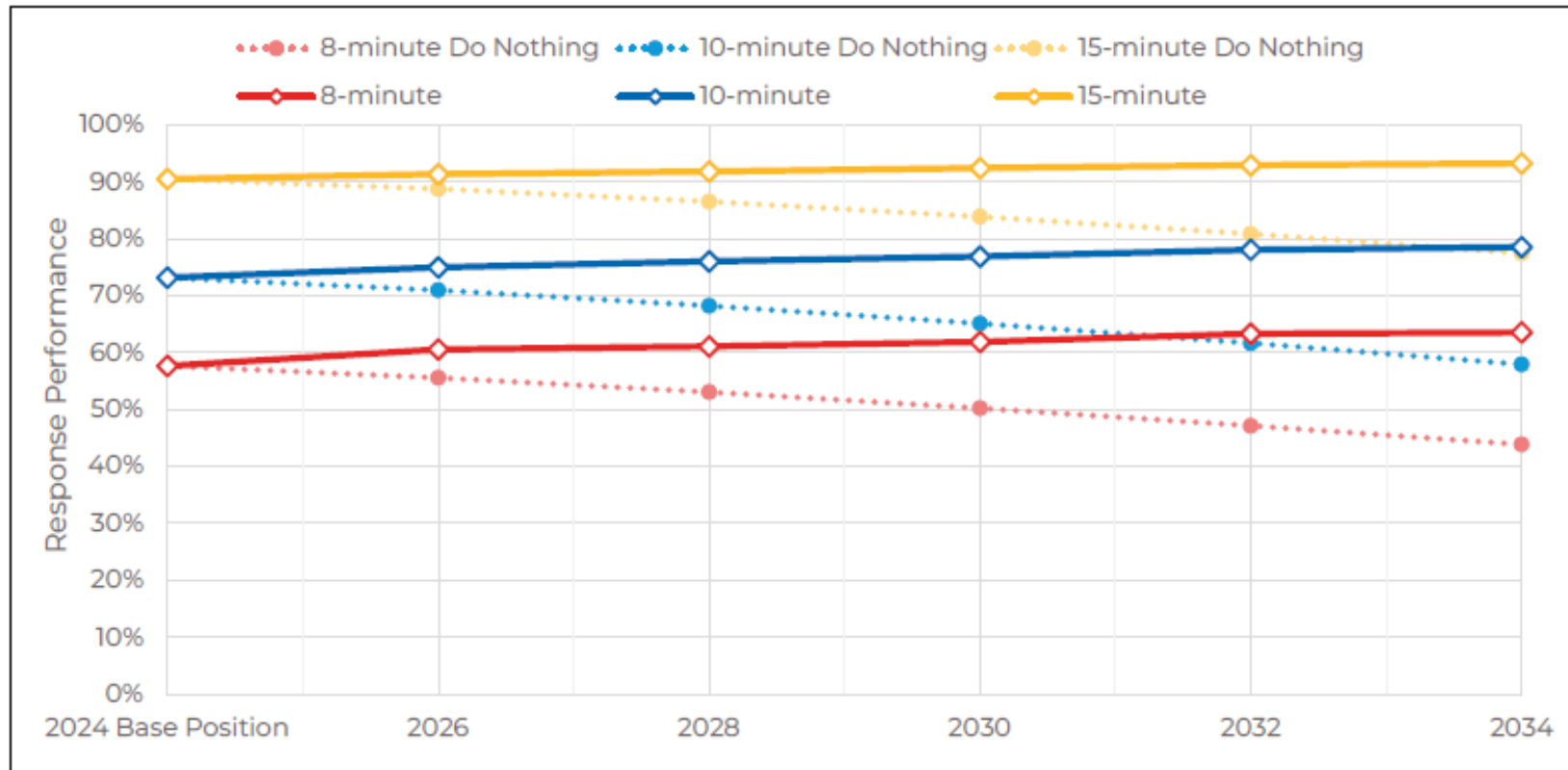

Paramedic Stations

- Many of the current facilities are relatively well located
- Facilities are not appropriately sized or purpose-built
- Capacity constraints prevent additional resources
- Challenges:
 - Land availability in optimal locations
 - Financial capacity for land and construction dictates pace

ORH Report - Recommended Station Construction Sequence

YEAR	LOCATION
2026	Guelph (Speedvale Avenue)
2028	Erin (Hillsburgh)
2028	Guelph-Eramosa (Rockwood)
2030	Minto (Harriston)
2030	Wellington North (Mount Forest)
2032	Centre Wellington (Fergus)
2032	Puslinch (Aberfoyle)
2034	Wellington North (Arthur)
2034	Mapleton (Drayton)
2034	Guelph (Gordon Street)

Proposed Station Layout

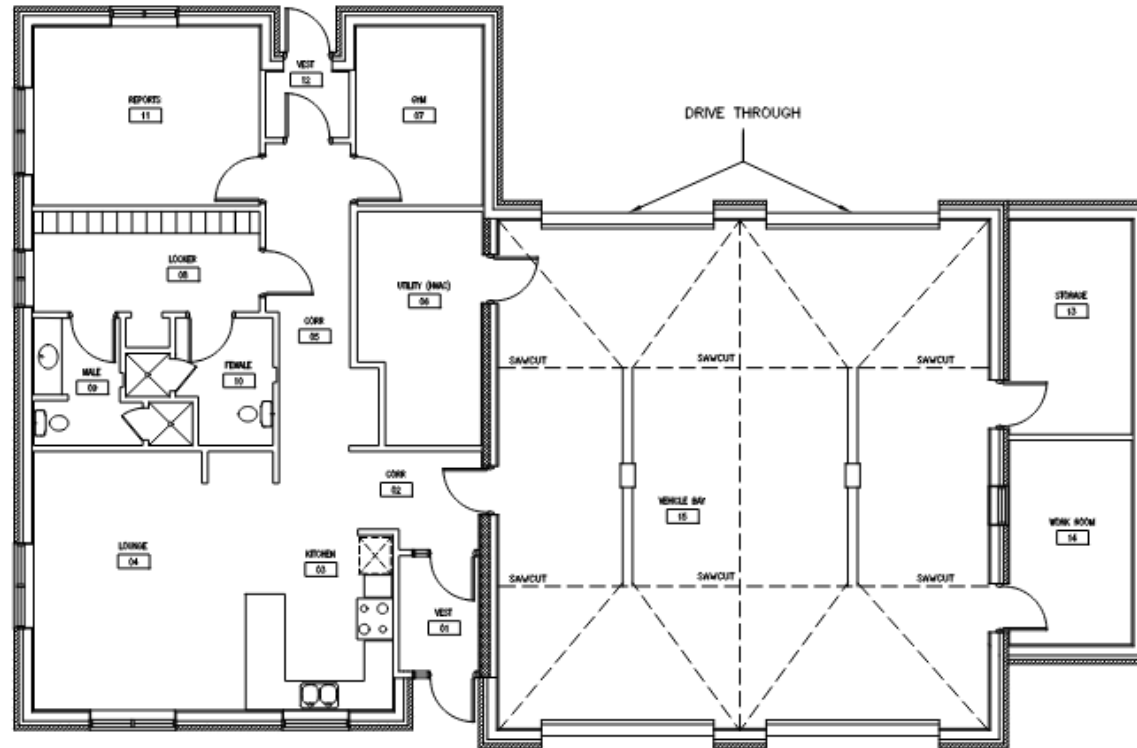

Note: Station is approximately 3400 sq ft.

GWPS County Station Cost Estimate

Information for budgeting purposes:

- Construction meeting Post Disaster Building Standard
- Land acquisition cost is extra
- Budgetary station cost is \$1390 / sq ft⁽¹⁾
- Station budget cost estimate for 3400sq ft is \$4.7M

Questions?