

# COUNTY OF WELLINGTON JOINT SOCIAL SERVICES AND LAND AMBULANCE COMMITTEE MEETING

**JUNE 12, 2024**

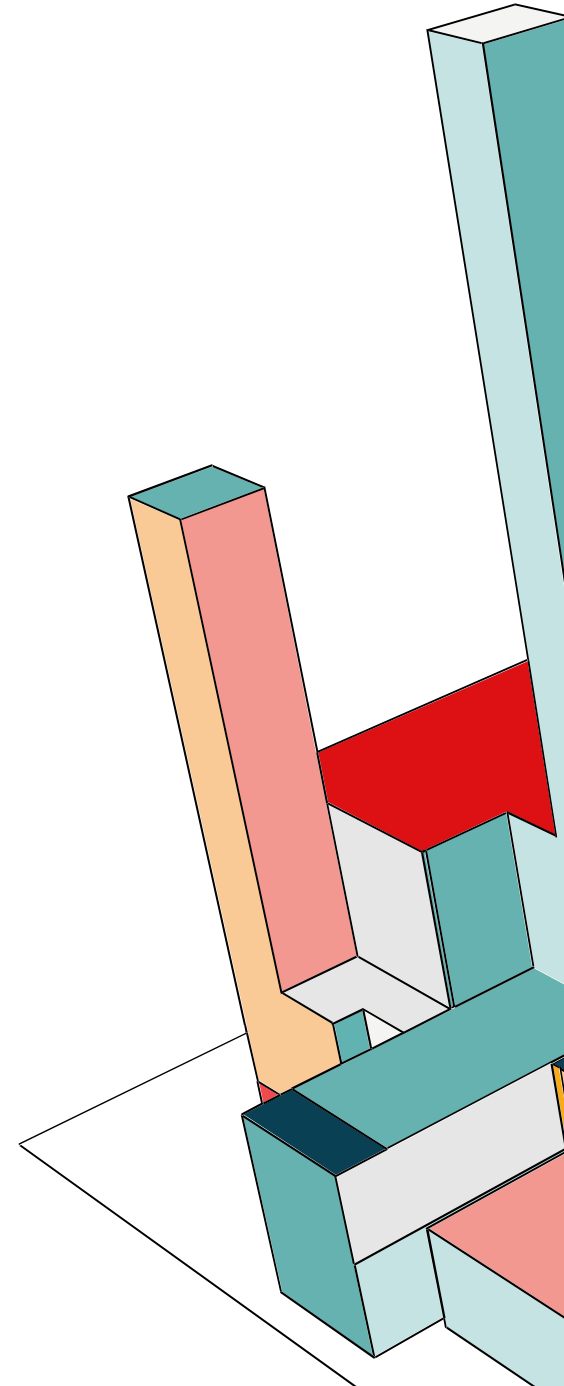

**Guelph Tiny Homes  
Coalition**



# WHO WE ARE

Members of the coalition are health care and substance use specialists, faith community representatives, business representatives and homebuilders, community organizers and people with lived experience.

We share a strong belief that in a city as prosperous and caring as Guelph, no one should be sleeping in a tent and that a community-led pilot is a fast and effective way to house individuals while longer-term housing options are being developed.



**Guelph Tiny Homes  
Coalition**

# VISITING A BETTER TENT CITY AND ERB ST. SITES





## WHAT WE ARE PROPOSING

- A Tiny Home Pilot Community of 25-50 homes for people currently unhoused to support stabilization while longer-term housing options are developed in our community.
- The pilot community will be supported 24/7 by a team of volunteers and staff and will include healthcare services and additional supports as needed/identified by the residents.
- The goal of this pilot will be to help the people who have fallen through the gaps in our system to have a safe housing option, and support them through the next step of their housing journey.
- This model has been implemented in other communities across Canada (Kitchener, Peterborough, Fredericton) and is proven to be an effective high-speed, low-cost housing option.
- Our goal is to have the community area and tiny homes built by winter 24/25.

# KEY GOALS

1. To identify the best location in the City of Guelph for a Tiny Home Community to meet the needs of its unhoused community members.

2. To develop a site plan and seek approvals for a tiny home community on the preferred site.

3. To develop partnerships and leverage community and business resources to build a tiny home community before the Winter of 2024/25.

4. To deliver a community-led model for building and maintaining a Tiny Home Community that is cost effective and person-centered.

# WHAT WE HAVE DONE SINCE JANUARY, 2024

- Drafted a Project Charter to clearly communicate how this project can contribute as a housing option.
- Incorporated as a non-profit and established a Board of Directors.
- Worked with a builder and designer on blueprints for safe tiny homes.
- Received a commitment from a charitable organization to provide tax receipts for the project.
- Recruited over 65 volunteers and received unsolicited commitments for in-kind donations by many Guelph-based manufacturers and businesses.

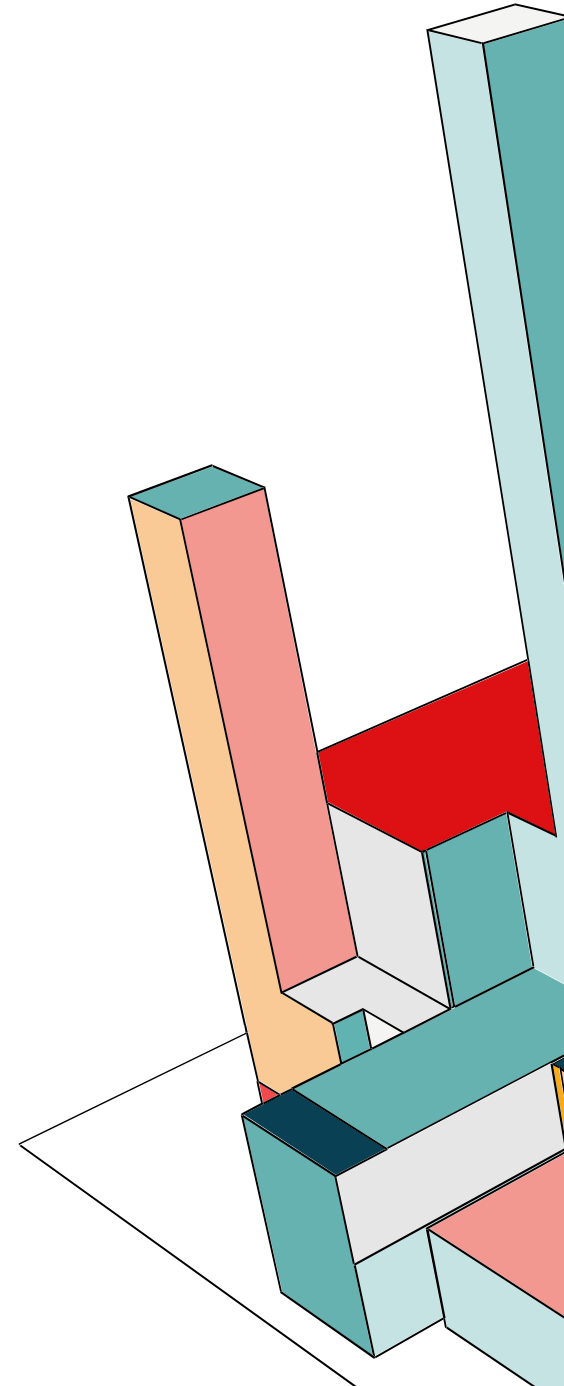

- 
- Arrived at an agreement in principle with Royal City Mission to support the coordination of services with Guelph-based health and social service providers.
  - Met with the City of Guelph and The County of Wellington officials.
  - Gained support from many key social service agencies that provide services to the people we are trying to house.
  - Secured an ongoing commitment from the same social services to continue to provide services at the Guelph Tiny Home<sup>7</sup> Community.



## SERVICE PROVISION FRAMEWORK

### Begin with Shelter

Work with GTHC in Selecting Community Members  
Navigate Tenancy Agreements with GTHC and Community  
Work to make GTHC site "home"



### Ensure Basic Needs

1 Meal provided each day, along with continental breakfast  
Create sense of safety and security  
Support individual's efforts to access other services (ie.)  
Food, Laundry, Healthcare etc.



### Build Community

Meals in community space  
Games, recreation and hobbies  
Weekly check-in  
Develop Community Agreements



### Meaningful "Task"

Site maintenance- "chores"  
Community Garden  
Food prep  
Volunteering  
Employment



## Service Provision



# SUPPORT REQUIRED FROM THE CITY OF GUELPH:

1. Support from the City of Guelph in the form of municipal land that is serviced and close to amenities and/or transportation.
2. Designation of the project as a “Public Use” in order to fastrack zoning approvals so we can have homes ready for this winter.
3. In-kind services (infrastructure, garbage pick-up, bus connection) and permitting assistance to enable building to start ASAP with providing homes to those who are experiencing homelessness.
4. Financial support to be discussed.



**Guelph Tiny Homes  
Coalition**

# SUPPORT REQUIRED FROM THE COUNTY OF WELLINGTON:

1. Integration of the Guelph Tiny Homes Project with the County's "By-Name List".
2. Similarly to Kitchener-Waterloo projects, that the County facilitate that the ODSP and OW shelter allowance from residents can be used to support the delivery of the Guelph Tiny Homes Project.
3. That the Guelph Tiny Homes Project is integrated in the County's housing continuum pipeline. Integration will ensure an exit strategy for residents.



**Guelph Tiny Homes  
Coalition**

Liz Hales, Kevin Coghill and Mike Marcolongo

519-731-8978

[guelphtinyhomes@gmail.com](mailto:guelphtinyhomes@gmail.com)

Guelphtinyhomescoalition.com

**THANK YOU**

